



Simply Engineered Better

Project \_\_\_\_\_  
 Item No. \_\_\_\_\_  
 Quantity \_\_\_\_\_

UNDERCOUNTER ACCESSORIES

## Undercounter Accessories

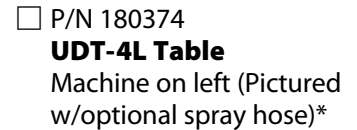
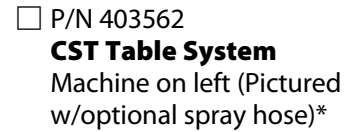

### OPTIONS FOR TABLES

- Spray Hose with hot & cold mixing chamber (\*pictured with both tables) P/N 100243
- 42" Overshelf – wall mounted stainless steel P/N 108189
- Garbage Disposal Unit – consult the factory P/N 110073
- Faucet
- 8" Back Splash

MD028 Printed in U.S.A.

**Moyer Diebel – USA**  
 P.O. Box 4183, Winston-Salem, NC 27115 Tel: 336/661-1992 Fax: 336/661-1979 800/228-8350 www.moyerdiebel.com

**Moyer Diebel Ltd. – Canada**  
 2674 North Service Rd., Jordan Station, Ontario, Canada L0R 1S0 Tel: 800/263-5798 Fax: 905/562-4618  
 sales@moyerdiebellimited.com



Dimensions shown in inches and [millimeters]

## Details & Specifications

### UDT Right Hand Sink

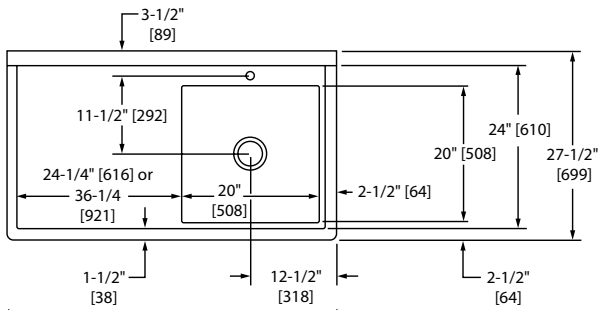

Plan View

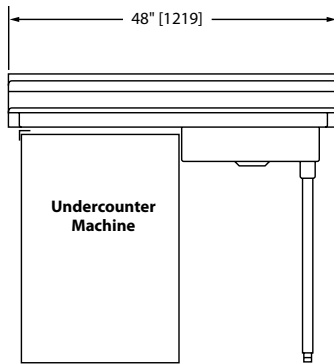

Front View

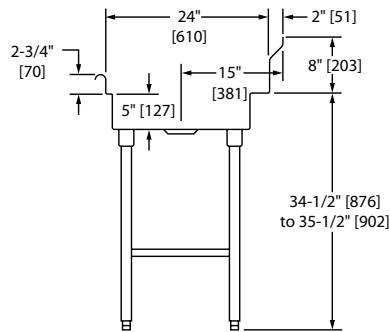

Side View

### CST Right Hand Sink

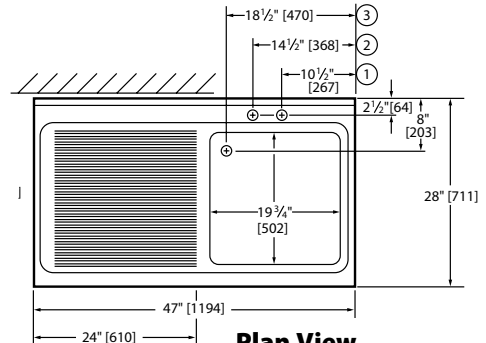

Plan View

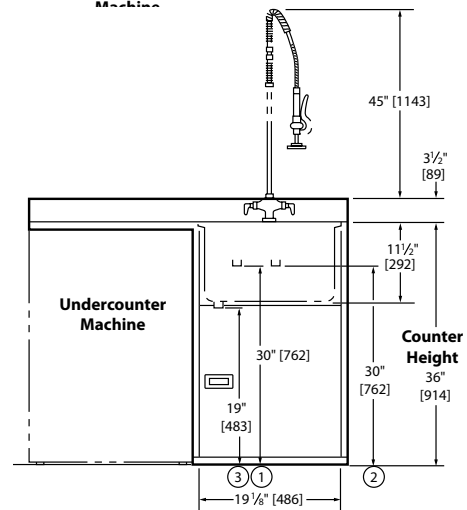

Front View  
(Shown with optional spray hose)

Utilities	
1	1/2" NPT hot water
2	1/2" NPT cold water
3	1-1/2" drain [38mm] drain

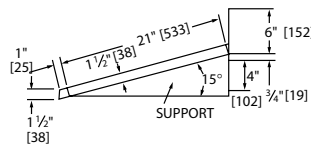

Wall Mounted  
Overshelf

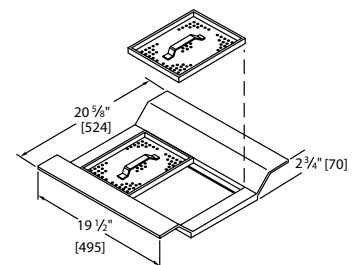

Removable Scrap  
Screen Holder  
(CST only)

## SPECIFICATIONS

Approximate shipping weight

UDT: 100 lbs/45 kg.  
CST: 167 lbs/76 kg.

Approximate shipping weight with shelf

UDT: 120 lbs/55 kg.  
CST: 187 lbs/85 kg.

## STANDARD FEATURES

- Constructed of heavy-gauge stainless steel.
- Specify right hand or left hand sink.