



7750 Georgetown Road, Indianapolis, IN 46268
 Sales: 317.634.2550 Tech Service: 887.368.2797

LP & Natural Gas Radiant Charbroilers

69K-786 / 2 Burner / 70,000 BTU

69K-787 / 3 Burner / 105,000 BTU

69K-788 / 4 Burner / 140,000 BTU

KRATOS Countertop Gas Radiant Charbroilers give you the ample space needed to grill meats, chicken, fish and vegetables. The burners are positioned under a radiant (an angled piece of metal) to direct the heat up toward the grates and food for consistent and quality cooking. This angle also channels grease away from the flame and into the drip pan for easier clean-up.



69K-786



69K-787



69K-788

CONSTRUCTION & FEATURES

- Stainless steel body construction for long life and easy maintenance
- Reversible, heavy duty cast iron grilling grates (different grill marks on each size)
- Grates are in individual sections and designed to be tilted for different heating levels
- Manually controlled 35,000 BTU independent burners
- Large burner control dials
- Bottom-mounted waste tray for easy clean up
- Angled sidewalls and bottom plate reflect heat into cooking zone for better and more accurate heat distribution
- Easily monitored gas valve and continuous pilot provide simple reliable regulation of the gas burner
- Adjustable feet for stability
- Back and side slashes protect walls and countertops
- Meets all North American gas cooking appliance design, construction and performance regulations, safety standards and design codes
- Easily convertible to a char-rock broiler with optional lava rock kit (sold separately)
- Units come equipped for Natural Gas, kit to convert to Liquid propane (including orifices) is included
- Electricity not needed.

ACCESSORIES (OPTIONAL)

- Lava Rock Kit & Holding Rack (sold separately)

	69K-786	69K-787	69K-788
# of Burners & BTUs	2 Burners @ 35,000 BTU	3 Burners @ 35,000 BTU	4 Burners @ 35,000 BTU
Total BTU / Hour	70,000 BTU per Hour	105,000 BTU per Hour	140,000 BTU per Hour
Hose Connection	.75"	.75"	.75"
in: Dimensions (W x D x H)	24" x 27.6" x 15.2"	36" x 27.6" x 15.2"	48" x 27.6" x 15.2"
mm: Dimensions (W x D x H)	610 x 701 x 386	914 x 701 x 386	1219 x 701 x 386
Shipping Weight	147 lbs	205 lbs	256 lbs

Commercial Duty
 3rd Party Approvals:



Intertek
 5004906

Intertek

Conforms to ANSI STD Z83. 11-2016
 Certified to CSA STD 1.8-2016
 Conforms to NSF/ANSI Std.4

The built in performance enhancing functions ensure that given proper attention and preventative maintenance each model will deliver years of trouble-free, reliable, low-maintenance, efficient operation.



7750 Georgetown Road, Indianapolis, IN 46268
 Sales: 317.634.2550 Tech Service: 887.368.2797

LP & Natural Gas Radiant Charbroilers

69K-786 / 2 Burner / 70,000 BTU
 69K-787 / 3 Burner / 105,000 BTU
 69K-788 / 4 Burner / 140,000 BTU

DIMENSIONS

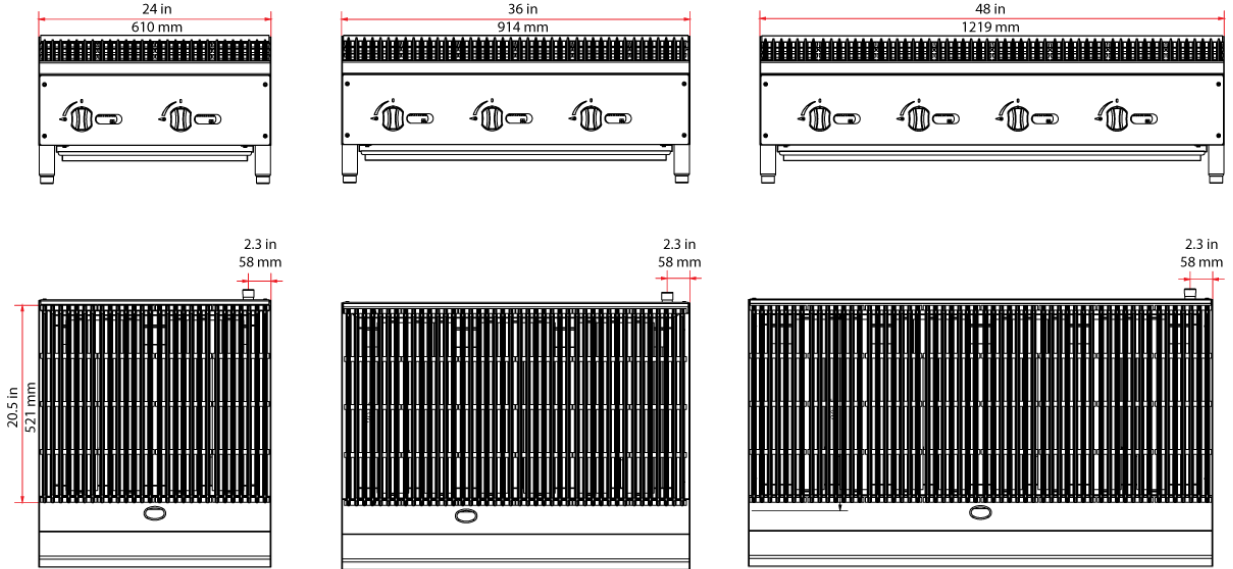

Model	W x D x H (in)	W x D x H (mm)
69K-786	24 x 27.6 x 15.2	610 x 701 x 386
69K-787	36 x 27.6 x 15.2	914 x 701 x 386
69K-788	48 x 27.6 x 15.2	1219 x 701 x 386

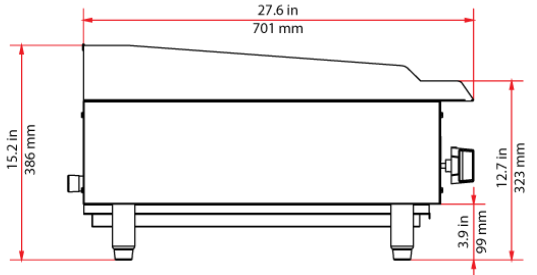

GAS SUPPLY AND BURNER INFORMATION

Supply pressure should be at minimum of 4" W.C. for natural gas or 10" W.C. for propane. The charbroiler comes with 3/4" NPT male connector on a 1/2" pipe, allowing you to connect with either 3/4" or 1/2" NPT female connector.

Model	Gas Type	Manifold Pressure	Rate Each BTUs / Hour	Total Rate BTUs / Hour	Orifice Size
69K-786	Natural Gas	4" W.C.	35,000	70,000	#36
	LP	10" W.C.	35,000	70,000	#50
69K-787	Natural Gas	4" W.C.	35,000	105,000	#36
	LP	10" W.C.	35,000	105,000	#50
69K-788	Natural Gas	4" W.C.	35,000	140,000	#36
	LP	10" W.C.	35,000	140,000	#50

- * Minimum supply pressure is 4" W.C. for natural gas and 10" W.C. for propane.
- ** Orifice sizes are for units installed at altitudes between 0 and 2000 feet above sea level.
- *** Gas powered appliances must always be installed indoors, under an approved exhaust system with grease removal filters and a fire protection system.